

Paper Model Building Techniques

The folds of the model are indicated by dotted lines. To help fold the pieces at a crisp and straight corner, score the fold line first by running your knife gently along a ruler to scratch just the upper third of the paper.

Practice scoring a few pieces of scrap paper to test how deeply to scratch the paper.

To score a valley fold (see symbols to right) on the reverse side of the paper, first poke a hole at each end of the fold line. Then flip the paper over and line up your ruler along the two holes to score the fold line.

Cut out the pieces along the black outline. You can use a small scissors or a hobby knife and ruler on a cutting mat. A new blade makes it easier to cut the tiniest pieces and straight edges.

Spread a small amount of glue on the tabs or edges to be connected. Once the pieces are positioned correctly, squeeze the flat sides together with fingers or a tweezer to set and dry the glue quickly.



To bend the curved chimney piece, press the paper around a dowel, pencil, or other round object to give it a smooth curve.

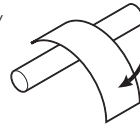

You can use a toothpick to push the small pieces into the right position before the glue dries.

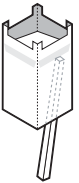

Symbols

	Fold the paper back (known in origami as a "mountain fold")
	Fold the paper forward (known in origami as a "valley fold")
	Cut piece along edge
	Cut out this area

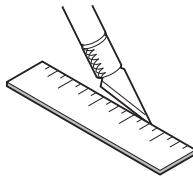
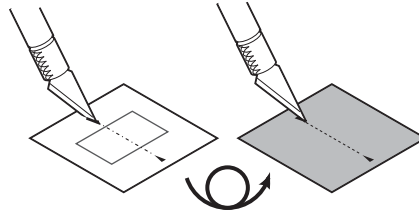
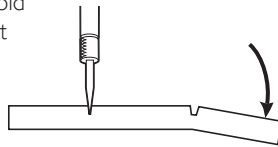

How to Build the Chicago Cultural Center Model (simplified version)

1 Cut out the two side walls.

Glue the two side walls together form a rectangle.

Fold the north stairs outward (valley fold).

Glue the two stair levels below the folded-out top of the stairs.

Cut out and fold the north porch. Glue the roof of the porch inside the columns.

Glue the north porch in place at the top of the stairs.

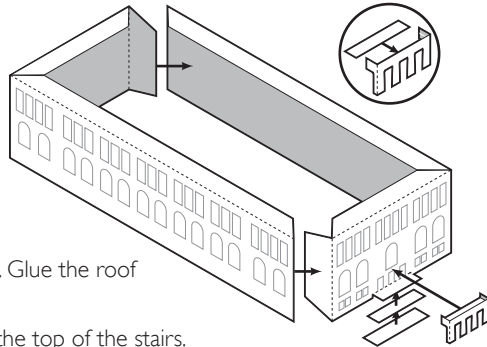

2 Fold the south stairs outward (valley fold).

Glue the two stair levels below the folded-out top of the stairs.

Cut out and fold the recessed wall piece. Glue in place inside the center of the south wall.

Cut out and fold the balcony. Glue the floor of the balcony to the recessed wall piece and sides of the balcony to the outer south wall.

Glue the roof in place.

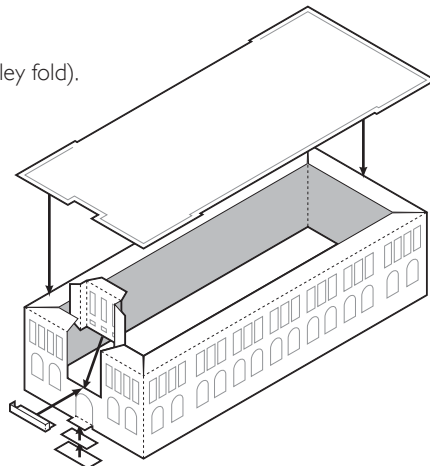

3 Score and cut out the roof railings. Fold the railing back and forth to match the outline of the roof. Put a little glue on the bottom edge of the paper and set in place.

Assemble the little rooftop building and glue in place.

Cut out the chimney and roll the piece around a round stick to create a cylinder. Glue the top of the chimney in place and then glue to the rooftop.

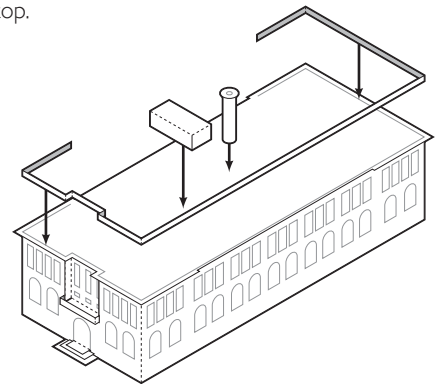

Produced in conjunction with *aroundcenter* exhibition by Jan Tichy, February 1-April 27, 2014, Chicago Cultural Center: www.aroundcenter.org
 Wurlington Press
www.BuildYourOwnChicago.com
 ©2014 Matt Bergstrom

How to Build the Chicago Cultural Center Model (complex version)

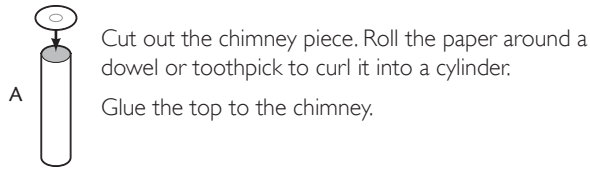

Cut out the chimney piece. Roll the paper around a dowel or toothpick to curl it into a cylinder.
Glue the top to the chimney.

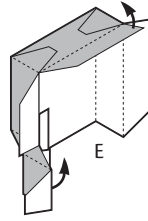

Cut out the loading dock area for the western wall. Note that many of the folds are reverse (valley) folds which are scored on the back of the paper. Fold and glue into an L-shaped box with the printing on the inside.

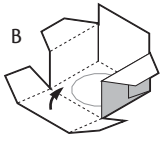

Score and cut out the south courtyard. Note that many of the folds are reverse (valley) folds which are scored on the back of the paper. Fold the sides in to make a box with the printing on the inside.

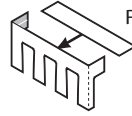

Cut out the north porch. You may find it easier to cut the piece out roughly, fold the corners and then cut out the individual columns.

Glue the porch roof in place inside the columns.

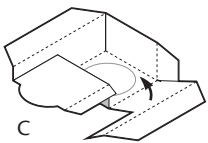

Score and cut out the north courtyard. Again many of the folds are reverse (valley) folds which are scored on the back of the paper. Fold the bottom of the courtyard into two levels in a stair-step shape, then fold the sides inward.

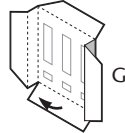

Cut out the south recessed wall. Note the reverse (valley) folds and assemble into the shape in the diagram.

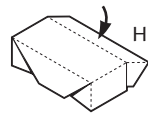

Cut out the rooftop mechanical building and assemble into a rectangular box.

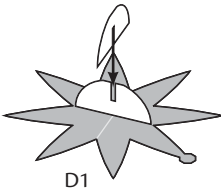

Cut out each star-shaped dome piece. Press the triangular sides of the dome against a round dowel to give them a bit of a curl.

Cut out the two interior forms of each dome, and slot together.

Place the printed side of the dome downward and glue the interior forms in line with the points between the triangular sides.

Bend the triangular side with the diamond shape in first. Put a little glue on the edge of the interior form to secure the triangle in place.

Fold in the triangular side opposite and glue in place. Continue with triangles opposite each other, leaving the side with the round end for last to cover over the seams of the other triangles.

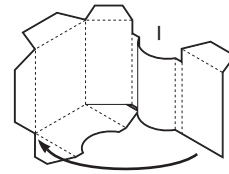

Cut out the central courtyard. Score the reverse (valley) folds on the back of the paper. Press the middle part of the wall against a round dowel to give it a curve to match the shape of the bottom of the courtyard.

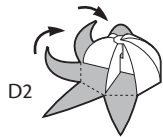

Cut out the two large walls and rooftop. Glue the walls together to create a rectangle.

Fold the north and south stairs outward (valley fold). Glue the two layers of stairs underneath the top stair. Glue the north porch "F" in place to the top of the north stair.

Glue loading dock "E" in place inside the west wall.

Glue recessed wall "G" in place inside the south wall.

Glue the rooftop to the top of the walls.

Add the balcony to the front of recessed wall "G".

Glue south courtyard "B" under the roof with the north wall sticking up through the hole in the roof.

Glue north courtyard "C" under the roof, then glue central courtyard "I" in place.

Cut out the rooftop railing. Fold into shape to match the outline of the roof. Place a little glue along the bottom edge of the railing and set in place.

Glue the rooftop mechanical building H to the roof, against the north wall of the south courtyard "B".

Glue the chimney "A" to the roof of "C".

Glue the two domes "D" inside the courtyards.

Now you are finished with your Chicago Cultural Center!

